

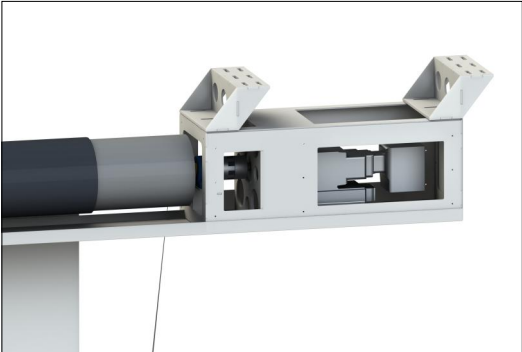

Projection screen is provided with a protective steel housing



Special system of tube and motor connecting - maximal safety operation



Special tension system TabTension for ideal flatness of projection surface

Mod	Overall / Image size in cm (W x H)	Code no.	Weight gross/net in kg	Package size in cm	Cross section in cm	Screen surface
500	500x400 / 500x400	45073	250/175	710x37x52	27	Foil base
600	600x400 / 600x400	45074	270/195	810x37x52	27	Foil base
700	700x500 / 700x500	45075	290/215	910x37x52	27	Foil base
800	800x500 / 800x500	45085	320/235	1010x37x52	27	Foil base
900	900x600 / 900x600	46096	450/345	1110x46x61	36	Foil base
1000	1000x600 / 1000x600	46106	490/385	1210x46x61	36	Foil base
1100	1100x600 / 1100x600	46116	550/435	1310x46x61	36	Foil base
1200	1200x600 / 1200x600	46126	610/485	1410x46x61	36	Foil base

THE STATIONARY MOTORIZED LARGE VENUE SCREEN FOR TRADE SHOWS, CONFERENCE HALLS, THEATERS AND CINEMAS ACCORDING TO §17 DGUV NORM (FORMERLY BGV C1) AND DIN 56950-4

The construction according to DIN 19045 Part 1-4 / Safety technology according to DIN 56950-4, regulation DGUV 17 Directive: EMC Directive (2004/108 / EC), Low Voltage Directive (2006/95 / EC), DIN EN ISO 12100-1, DIN EN ISO 12100-2, DIN EN ISO 13857, DIN EN 60335-1, DIN EN 60730-1 - control devices DGUV 17 (formerly BGV C1).

The bearing construction is formed with inner massive metal winding tube, suspended in two bearing hinges, which are connected with the steel brackets, which fix the screen to the building construction. Projection screen is also provided with a protective steel housing, which forms together with the winding tube sturdy construction of the product. The housing is coated in RAL 9003 with high-quality surface.

Sturdy square steel housing has two standard sizes defined by screen size - 27x27cm up to width of 800 cm width, 36x36cm up to width of 1200 cm.

The construction of the screen is equipped with two mounting brackets for mounting directly to the ceiling and one auxiliary bracket for secure fixing of gearbox with motor. The brackets are supplied as standard.

Body-sound-insulated, maintenance-free special winding shaft, secured against torsion at the motor side, low noise and vibration-free.

With defined enlacement of the screen surface on the winding tube according to DIN 56950.

Fixing of the screen surface is statically independent from fixing of the motor drive, electronically controlled double brake, dual mechanism against fall down.

The drive is maintenance-free. It consists of a three-phase motor 400V / 50Hz with IP54, screw mechanical gearbox, twin-limit switches and double break system. The motor is protected against overload electronically and simultaneously with heat fuse. The control electronics enables a smooth start and stop the engine to the end position by reducing the rotational speed and thereby eliminates the starting and driving shocks. Motor and cable entry at the right from the point of viewer. Automatic electrical end switch at the top and bottom.

Automatic switch with a cam circuit breakers is set up as an emergency circuit breaker, gearbox and engine disc brakes are equipped with separate sensors, which signalize failure of brakes in the control unit.- a control lamp on the panel.

The electronic control unit is placed in an external chassis connected by a cable to the motor drive.

Security systems are externally verifiable and can be automatically transmitted to the integrated control system.

Automatic documentation errors / integrated emergency stop / central switch
The integrated interface between the screen and the motor / operating with integrated control system.

The screen surface is certified to the high level of non-flammability B1 (French M1) according to DIN 4102.

Customized sizes, special colour of casing, different types of screens surfaces on request.